

D-106

1U Ultra-compact Rackmount Chassis



Features

- Signature Aluminum Front Panel
- Front Access USB2.0x1
- 40mmx3 cooling fan
- Performance front cold air intake tunnel
- Power and HDD LED
- Power and alarm reset switch
- Thumb screw 5.25 drive bay
- 32bit PCI riser card x1 (optional 64 bits)

Specifications

Model Number	Expansion Slots	Color of Main Chassis	
D-106	1	Black	
RoHS Compliance	Security	Front Connector	
YES	Front Bezel	Front USB 2.0 x 1 Connector	
Form factor	Material of Front Bezel	Motherboard Size	
1 U	Aluminum alloy	12 x 9.6 (ATX, microATX)	
Standard Drive Bays	Material of Handle	Cooling Fan	
2.5" Drive (internal): 2 5.25" Drives: 1	SECC Zinc-Coated Steel	3x40mm	
3.5" Drives: 1			
3.5" Drive (internal): 1			
Indicators	Material of Main Chassis	Dimensions (WxHxD)	
LEDs for Power ON/OFF, HDD, Fan & Alarm	1.2mm SECC Zinc-Coated Steel	Width	19.00" (482.6 mm)
		Height	1.75" (44.4 mm)
		Depth	20.00" (508.0 mm)
Switches	Color of Front Bezel		
Power ON/OFF, System & Alarm Reset	Black		

Front View



Inside View

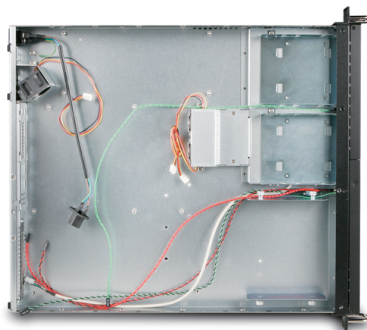

Rear View



We at iStarUSA Group offer OEM/ODM services for Industrial Power, Custom Power, Chassis, Cabinets, and Data Storage. Through our skilled metal bending, milling, and silk screening we can provide you with unique customizations that will make your product stand out from the rest. With iStarUSA Group's OEM/ODM Solutions you can be sure to receive one-of-a-kind products for your one-of-a-kind business.

Dimensions

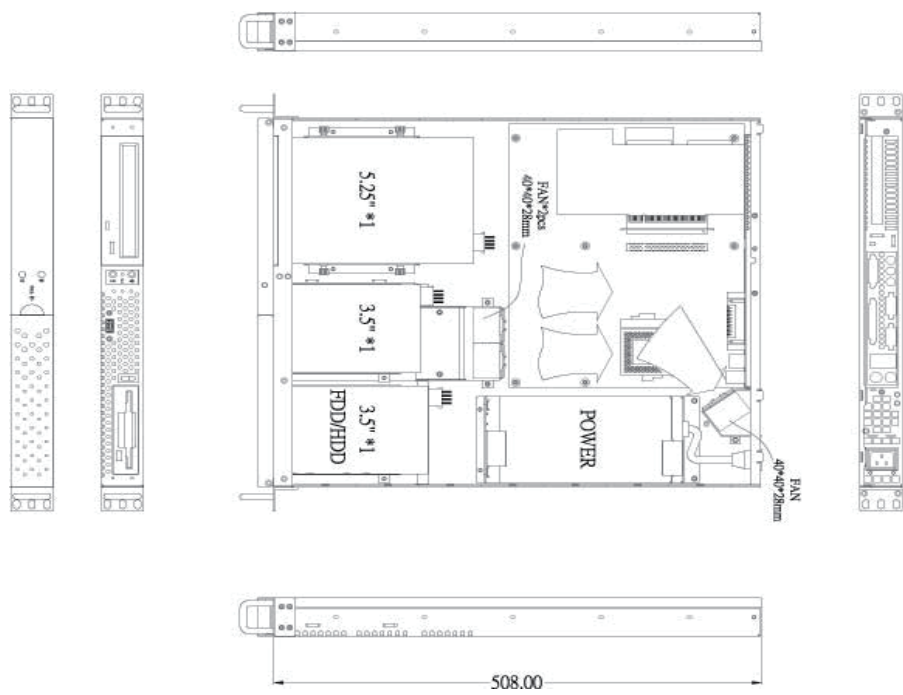

Ordering Information

Model	Description
D-106	1U Ultra-compact Rackmount Chassis

Compatible Power

PSU Model	Description
IS-1U40PD8	IS 1U 80PLUS 400W
IS-1U50PD8	IS 1U 80PLUS 500W

Optional Accessories

Category	Model
Drive Cage	BPN Trayless Drive Cage Series
	BPU Tray Drive Cage Series
Sliding Rail Kit	RP-RAIL Series Slim Sliding Rail Kit

Compatible Riser Card

Model	Description
DD-666-CX	PCIe x16 to PCIe x16 Riser Card
DD-611-CX	PCI to PCI Riser Card

** We offer a great selections of riser cards.Please contact our sales engineers for other specs of riser cards*