

# D-135-DE3

## 1U 3x 3.5" Bays Trayless ATX Chassis



### Features

- Supports full-size ATX motherboards
- 3 Trayless and hotswappable 3.5" bays for HDD quick swap
- 3x 40mm cooling fans
- Supports 6.0 Gb/s hard drives
- Rear-mount brackets included
- Compatible with 1U redundant power supply
- Sleek aluminum front with color options for HDD handles

### Specifications

Model Number	Supported PSU Type	Dimensions (WxHxD)	
D-135-DE3	1U	Width	17.44" ( 443.0 mm )
<b>RoHS Compliance</b>	<b>Expansion Slots</b>	Height	1.73" ( 43.9 mm )
YES	1	Depth	23.62" ( 599.9mm )
<b>Form factor</b>	<b>Material of Main Chassis</b>		
1 U	Steel		
<b>Standard Drive Bays</b>	<b>Color of Main Chassis</b>		
2.5" Drive (internal): 1 Hotswap 3.5": 3	Black		
<b>Hotswap HDD Type:</b>	<b>Motherboard Size</b>		
3.5" SAS I/II & SATA I/II/III	12 x 9.6 (ATX, microATX, mini-ITX)		
<b>Switches</b>	<b>Cooling Fan</b>		
Power	3x40mm		

### Front View



### Inside View



\*M/B not included

### Rear View



We at iStarUSA Group offer OEM/ODM services for Industrial Power, Custom Power, Chassis, Cabinets, and Data Storage. Through our skilled metal bending, milling, and silk screening we can provide you with unique customizations that will make your product stand out from the rest. With iStarUSA Group's OEM/ODM Solutions you can be sure to receive one-of-a-kind products for your one-of-a-kind business.

## Dimensions

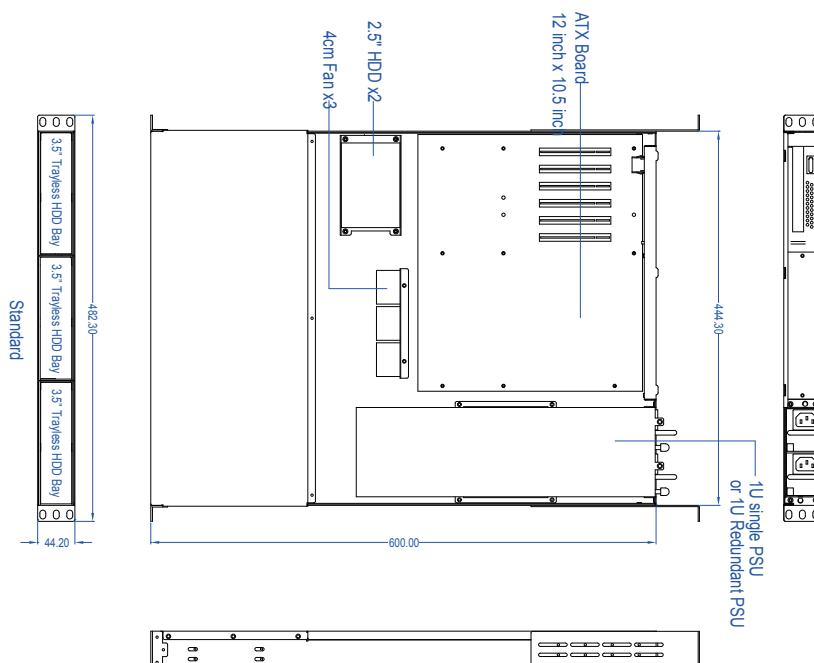

## Ordering Information

Model	Description
D-135-DE3BK	D-135-DE3 with Black HDD Handle
D-135-DE3BL	D-135-DE3 with Blue HDD Handle
D-135-DE3RD	D-135-DE3 with Red HDD Handle
D-135-DE3SL	D-135-DE3 with Silver HDD Handle
D-135-DE3WB	D-135-DE3 with Wood Look HDD Handle

## Compatible Power

PSU Model	Description
IS-1U40PD8	IS 1U 80PLUS 400W
IS-1U50PD8	IS 1U 80PLUS 500W

## Optional Accessories

Category	Model
FANS	DD-FAN40-Q
Sliding Rail Kit	TC-RAIL Series Sliding Rail Kit

## Compatible Riser Card

Model	Description
DD-666-CX	PCIe x16 to PCIe x16 Riser Card
DD-611-CX	PCI to PCI Riser Card

*\* We offer a great selections of riser cards. Please contact our sales engineers for other specs of riser cards*