

D-200-PFS

Inventory Type	Item No.
A	06;08;17;24;26;27;34;37;40
B	05;07;09;14;15;16;36
C	02;10;11;12;13;32
D	01;04;21;22;25;30;31;32;33;35;38;39

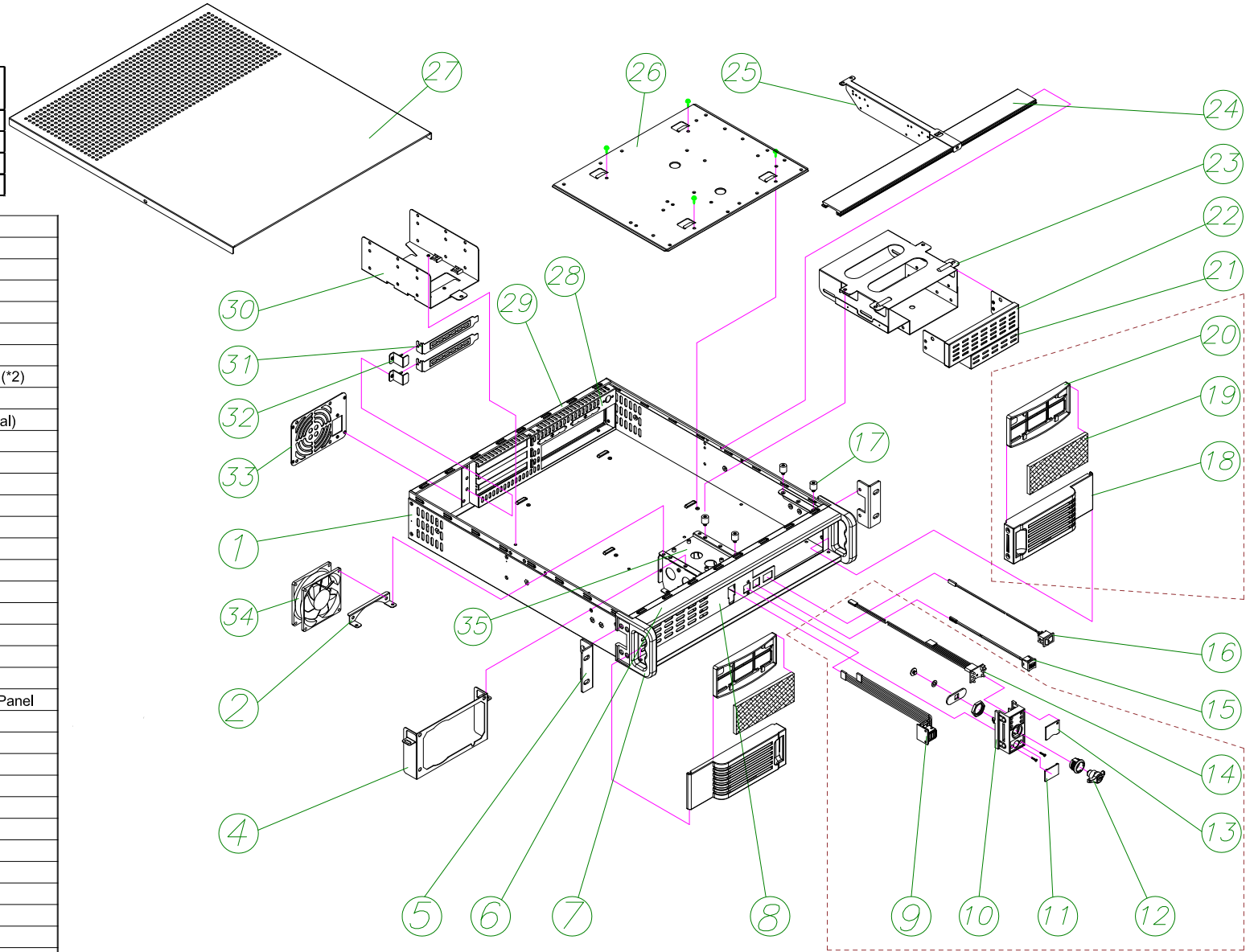

NO	PARTS NO	DESCRIPTION
01	DD-200-FRAME	Main Chassis
02	DD-FANBRT-60	6cm Fan Holder
03		
04	DD-PSBRT-2UFS	Power Lock Holder
05	DD-200-EAR-L	Side Holder (*2)
06	DD-FRONTBAR-PL	Decoration Bar(*2)
07	DD-200-HANDLE	Aluminum Alloy Handle (*2)
08	DD-200FS-FPANEL	Front Panel
09	DD-USBHEAD	USB Connector (Optional)
10	DD-LOCKHLD-2U	Lock Holder
11	DD-USB-ACRYL-2U	USB Acrylic
12	DD-KEYLOCK	Key Lock
13	DD-LED6-ACRYL	LED Acrylic
14	DD-LED	LED Indicator (*6)
15	DD-RESET	Reset Switch
16	DD-PWSWITCH	Power Switch
17	DD-STEELSTDF	
18		Plastic Door (*2)
19		Air Filter (*2)
20		Filter Holder (*2)
21	DD-35CVR	3.5" FDD Cover Panel
22	DD-525CVR	5.25" HDD/FDD Cover Panel
23		Disk Holder
24	DD-FANBAR	Support
25	DD-200-RISERBAR	RiserCard Holder
26	DD-ATX-MB-2U	M/B Mounting Plate
27	DD-VENTLID-2U	Top Cover(fan hole)
28		Back Window
29		Back Panel
30	DD-35CAGE-2UFS	H.D.D Frame
31	DD-SLOTCVR-SD	Slot Cover (*2)
32	DD-SLOTHLD	Slot Cover Holder (*2)
33	DD-ACBRT-2UFS	Power Change Plate
34	DD-FAN80S	80mm Fan 3pin
35	DD-CTRFRAME-2U	Central HDD Frame
36		
37		
38		
39		
40		

DD-CTRLKSET-2U
36

DD-200P-DB
37
DD-200-FILTER
38

DD-1B15-CAGE
39

DD-200-BP-STD
40