

D-200L-PFS

Inventory Type	Item #
A	03;07;09;18;27;28;36;38;42
B	06;08;10;15;16;17;37
C	11;12;13;14;31
D	01;02;05;22;23;25;26;29;30;34;35;39;40;41

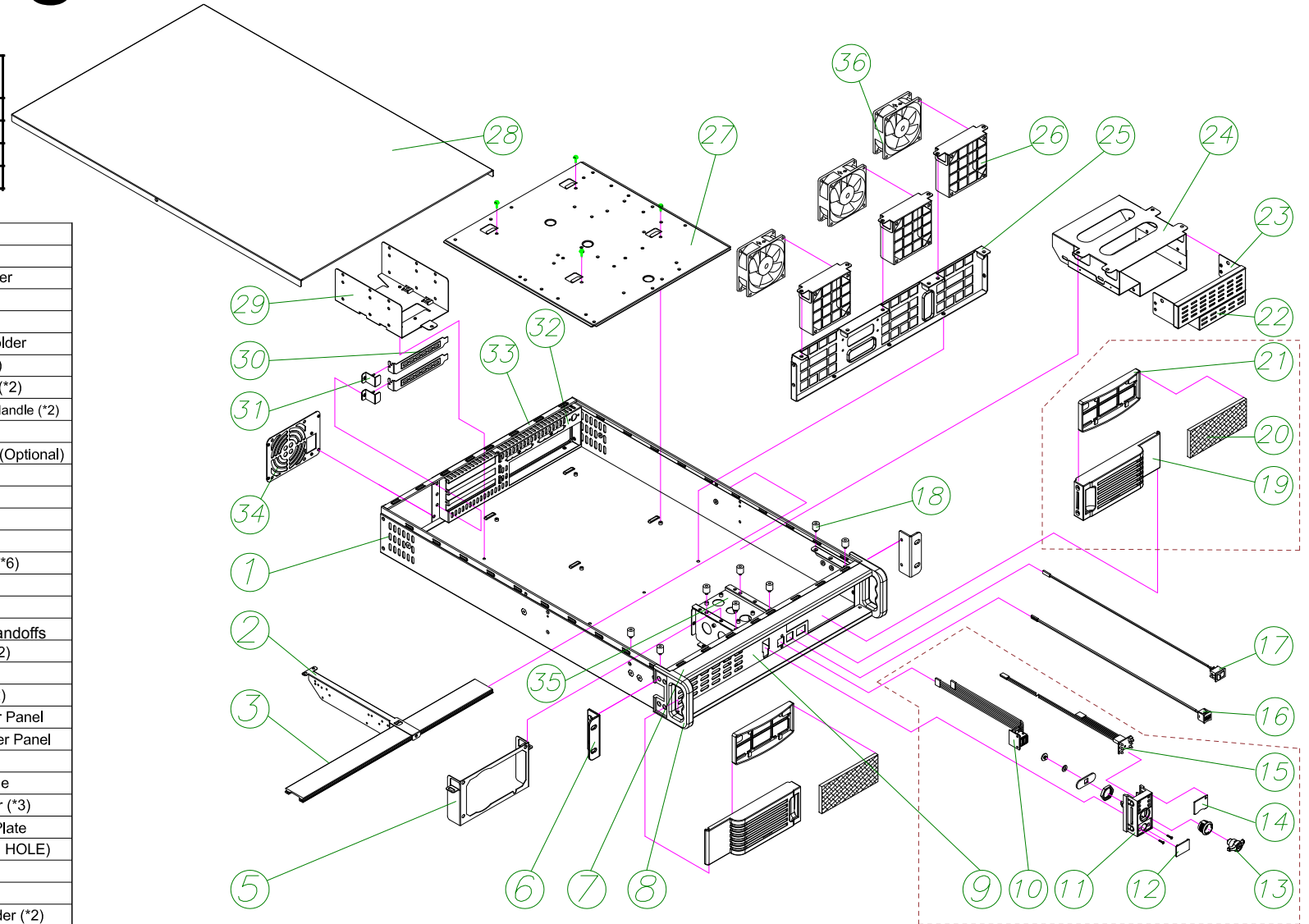

	NO	PARTS NO	DESCRIPTION
	01	DD-200L-FRAME	Main Chassis
	02	DD-200-RISERBAR-L	RiserCard Holder
	03	DD-FANBAR	Support
	04		
	05	DD-PSBRT-2UFS	Power Lock Holder
	06	DD-200-EAR-L	Side Holder (*2)
	07	DD-FRONTBAR-PL	Decoration Bar(*2)
	08	DD-200-HANDLE	Aluminum Alloy Handle (*2)
	09	DD-200FS-FPANEL	Front Panel
	10	DD-USBHEAD	USB Connector(Optional)
	11	DD-LOCKHLD-2U	Lock Holder
DD-CTRLKSET-2U	12	DD-USB-ACRYL-2U	USB Acrylic
37	13	DD-KEYLOCK	Key Lock
	14	DD-LED6-ACRYL	LED Acrylic
	15	DD-LED	LED Indicator (*6)
	16	DD-RESET	Reset Switch
	17	DD-PWSWITCH	Power Switch
	18	DD-STEELSTDF	Drive Cage Standoffs
DD-200P-DB	19		Plastic Door (*2)
38	20		Air Filter (*2)
DD-200-FILTER	21		Filter Holder (*2)
39			
DD-1B15-CAGE	22	DD-35CVR	3.5" FDD Cover Panel
40	23	DD-525CVR	5.25" FDD Cover Panel
	24		Disk Holder
DD-FANSET-2L	25	DD-FANFRAME-2U	Fan Array Frame
41	26	DD-FANHLD-8-2U	8cm Fan Holder (*3)
	27	DD-EATX-MB-2L	M/B Mounting Plate
	28	DD-SOLIDLID-2L	Top Cover(FAN HOLE)
	29	DD-35CAGE-2UFS	H.D.D Frame
	30	DD-SLOTCVR-SD	Slot Cover (*2)
	31	DD-SLOTHLD	Slot Cover Holder (*2)
DD-200-BP-STD	32		Back Window
	33		Back Panel
42	34	DD-ACBRT-2UFS	Power Change Plate
	35	DD-CTRFRAME-2U	Central HDD Frame
	36	DD-FAN80	80mm Fan 3pin
	37		
	38		
	39		
	40		