

Low profile x 4

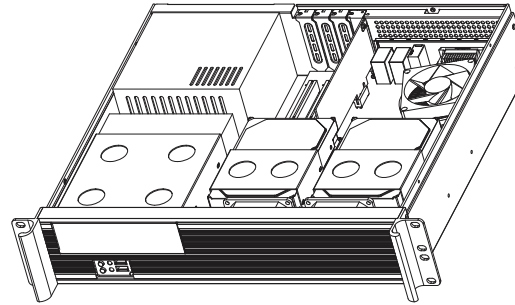

Model NO	D-213-MATX-B124
Ext	5.25"x1
Hid	3.5"x2
M/B	9.6"x9.6"
Fan	8.0CMx2(Optional)
Slot	4 (Low Profile)
Rev	

PS2 Power

9.6" x 9.6" Micro ATX

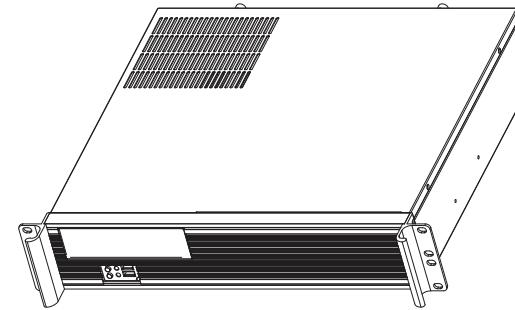
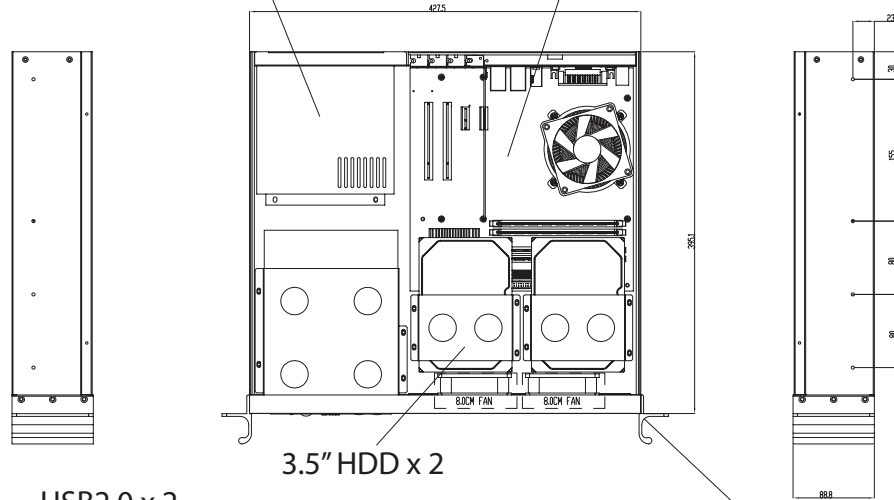

比例 1:2

3.5" HDD x 2

USB2.0 x 2

5.25" x 1 bay

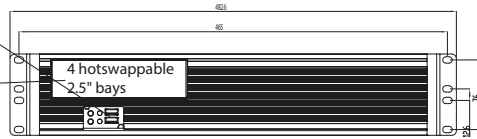

Power LED

Power switch

Reset

HDD LED

8.0cm Fan x 2(optional)

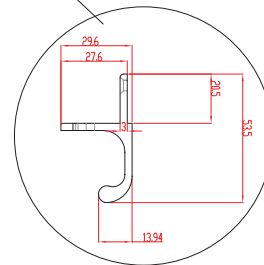

NOTE:

1. 材质要求环保 (RoHS);
2. 机箱外表面粉烤黑色。

MATL	SGCC T12	DATE	REV	AD	HW	APP	BY
FINISH	SEE NOTE	3-15	1.0	1.0	1.0	1.0	1.0
DRAWN		13-09-18	6-10	1.0	1.0	1.0	1.0
DESIGN		13-09-18	13-09	1.0	1.0	1.0	1.0
CHECKED		13-09-18	13-09	1.0	1.0	1.0	1.0
APPROVED		13-09-18	13-09	1.0	1.0	1.0	1.0

2014/08/18