

# D-230HB-DT

## 2U Compact 3x 3.5" Bay Hotswap microATX Desktop Chassis



### Features

- 3 hotswappable 3.5" bays for HDD quick swap
- Compatible with 2.5" HDDs/SSDs
- Supports standard ATX power supplies
- Slim optical drive bay (12.7mm height) available
- USB 3.0 in front for easy access
- Sleek aluminum front w/ various color options for HDD handles
- Rackmount or desktop convertible
- Supports 6.0 Gb/s hard drives

### Specifications

Model Number	Switches	Front Connector
D-230HB-DT	Power	2x USB 3.0
RoHS Compliance	Expansion Slots	Motherboard Size
YES	4 (Low profile)	9.6 x 9.6 (microATX, mini-ITX)
Form factor	Material of Front Bezel	Cooling Fan
2 U	Aluminum	1x80mm
Standard Drive Bays	Material of Handle	Dimensions (WxHxD)
2.5" Drive (internal): 1 Hotswap 3.5": 3 3.5" Drive (internal): 1 Slim 5.25" Optical: 1	Aluminum	Width 18.98" ( 482.1 mm ) Height 3.48" ( 88.4 mm ) Depth 14.95" ( 379.7 mm )
Hotswap HDD Type:	Material of Main Chassis	
3.5" SAS I/II & SATA I/II/III	SGCC 0.8mm	
Indicators	Color of Main Chassis	
Power, HDD	Black	

### Front View



### Inside View

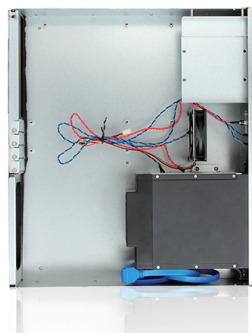

### Rear View



We at iStarUSA Group offer OEM/ODM services for Industrial Power, Custom Power, Chassis, Cabinets, and Data Storage. Through our skilled metal bending, milling, and silk screening we can provide you with unique customizations that will make your product stand out from the rest. With iStarUSA Group's OEM/ODM Solutions you can be sure to receive one-of-a-kind products for your one-of-a-kind business.

**Dimensions**

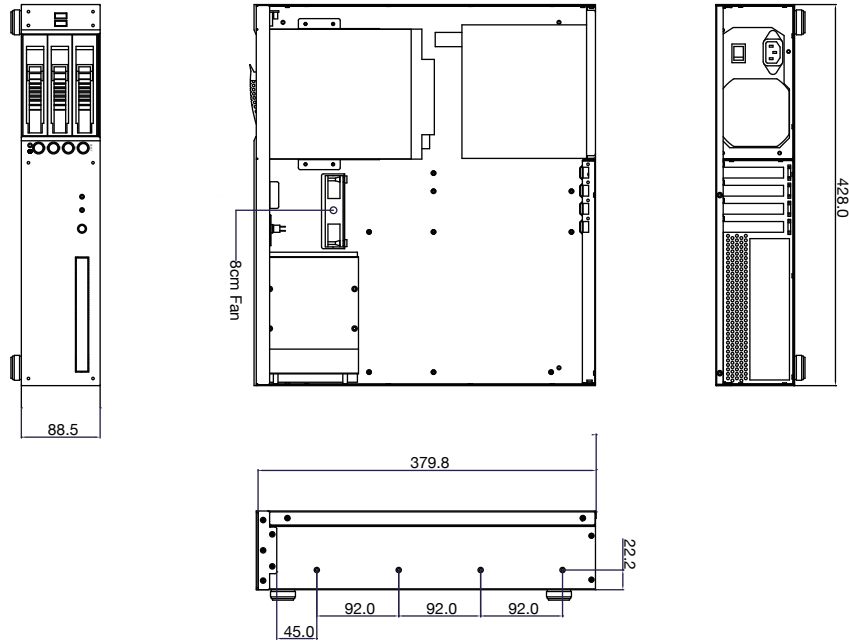

**Ordering Information**

Model	Description
D-230HB-DT	D-230HB-DT with Black HDD Handle
D-230HB-DT-BLUE	D-230HB-DT with Blue HDD Handle
D-230HB-DT-RED	D-230HB-DT with Red HDD Handle
D-230HB-DT-SILVER	D-230HB-DT with Silver HDD Handle

**Compatible Power**

PSU Model	Description
TC-500PD8B	ATX 500W 80PLUS Bronze
TC-700PD8B	700W 80PLUS Bronze ATX PSU

**Optional Accessories**

Category	Model
Sliding Rail Kit	TC-RAIL Series Sliding Rail Kit