

# E-30

## 3U Rugged 15" Compact Rackmount Chassis



### Features

- Compact 15" Depth
- 1.6mm Steel Body Chassis
- Shock Absorbing Drive Cage
- Front Access USB2.0 x2
- Removable Air Filter
- Fan and Temperature Monitor Option
- Industrial Keylock Bezel

### Specifications

Model Number	Security	Air Filter	
E-30	Front Bezel	Removable & Washable	
RoHS Compliance	Material of Front Bezel	Motherboard Size	
YES	1.6mm SECC Zinc-Coated Steel	12 x 9.6 (ATX, microATX)	
Form factor	Material of Handle	Cooling Fan	
3 U	1.6mm SECC Zinc-Coated Steel	1x60mm, 2x80mm	
Standard Drive Bays	Material of Main Chassis	Dimensions (WxHxD)	
3.5" Drive (internal): 1    5.25" Drives: 1 3.5" Drive (internal): 3	1.6mm SECC Zinc-Coated Steel	Width	19.00" ( 482.6 mm )
<b>Indicators</b> LEDs for Power ON/OFF, HDD, Fan & Alarm	<b>Color of Front Bezel</b> Black	Height	5.19" ( 131.8 mm )
		Depth	15.00" ( 381.0 mm )
Switches	Color of Main Chassis		
Power ON/OFF, System & Alarm Reset	Black		
Expansion Slots	Front Connector		
7	Front USB 2.0 x 2 Connector		

### Front View



### Inside View



### Rear View



We at iStarUSA Group offer OEM/ODM services for Industrial Power, Custom Power, Chassis, Cabinets, and Data Storage. Through our skilled metal bending, milling, and silk screening we can provide you with unique customizations that will make your product stand out from the rest. With iStarUSA Group's OEM/ODM Solutions you can be sure to receive one-of-a-kind products for your one-of-a-kind business.

## Dimensions

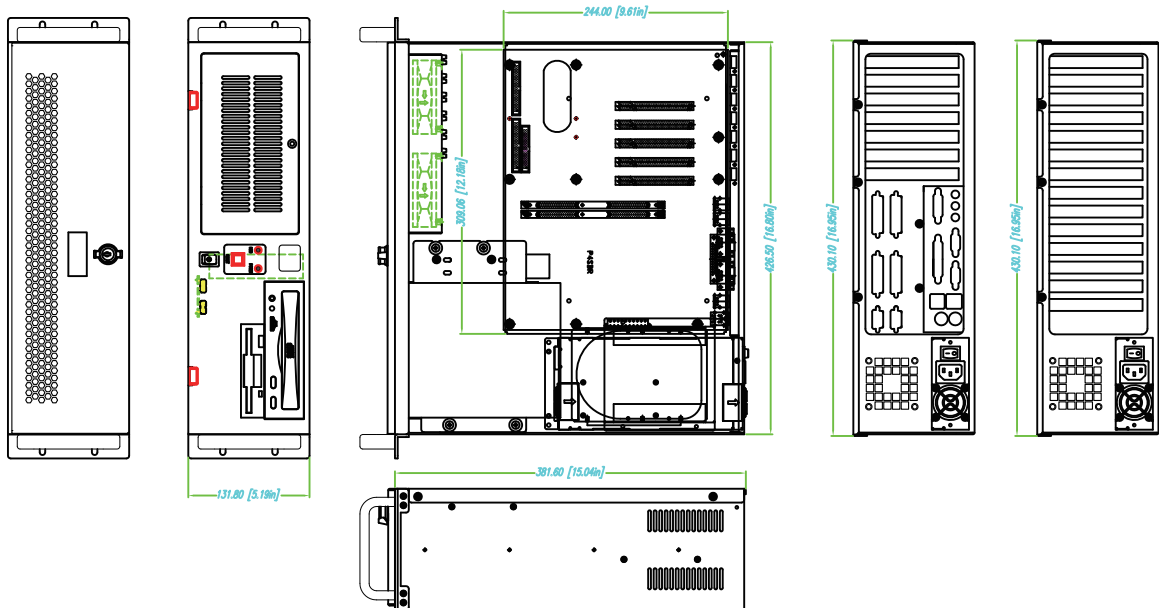

## Ordering Information

Model	Description
E-30	3U Rugged 15" Compact Rackmount Chassis

## Compatible Power

PSU Model	Description
IS-1U40PD8	IS 1U 80PLUS 400W
IS-1U50PD8	IS 1U 80PLUS 500W

## Optional Accessories

Category	Model
Drive Cage	BPN Trayless Drive Cage Series BPU Tray Drive Cage Series
Sliding Rail Kit	TC-RAIL Series Sliding Rail Kit