

# E-4140

## 4U Rugged 14-slot Compact 17" Rackmount Chassis



### Features

- 1.6mm steel body chassis
- Front access USB2.0 x1
- 120mm x1 cooling fan
- Removable air filter
- Spill-proof bezel with lock
- Shock absorbing drive cage
- 14 slot passive backplate
- Fan and temperature monitor
- Compact 17.8" depth

### Specifications

Model Number	Security	Air Filter	
E-4140	Front Bezel	Removable & Washable	
RoHS Compliance	Material of Front Bezel	Motherboard Size	
YES	1.6mm SECC Zinc-Coated Steel	Passive backplane/ Single board	
Form factor	Material of Handle	Cooling Fan	
4 U	1.6mm SECC Zinc-Coated Steel	1x120mm	
Standard Drive Bays	Material of Main Chassis	Optional Fan:	
3.5" Drives: 1      5.25" Drives: 3 3.5" Drive (internal): 1	1.6mm SECC Zinc-Coated Steel	1x80mm Blower	
Indicators	Color of Front Bezel	Dimensions (WxHxD)	
LEDs for Power ON/OFF, HDD, Fan & Alarm	Black	Width	19.00" ( 482.6 mm )
<b>Switches</b> Power ON/OFF, System & Alarm Reset	Black	Height	7.00" ( 177.8 mm )
		Depth	17.80" ( 452.1 mm )
Expansion Slots	Color of Main Chassis		
14	Black	Front Connector	
		Front USB 2.0 x 1 Connector	

### Front View



### Inside View



### Rear View



We at iStarUSA Group offer OEM/ODM services for Industrial Power, Custom Power, Chassis, Cabinets, and Data Storage. Through our skilled metal bending, milling, and silk screening we can provide you with unique customizations that will make your product stand out from the rest. With iStarUSA Group's OEM/ODM Solutions you can be sure to receive one-of-a-kind products for your one-of-a-kind business.

Dimensions

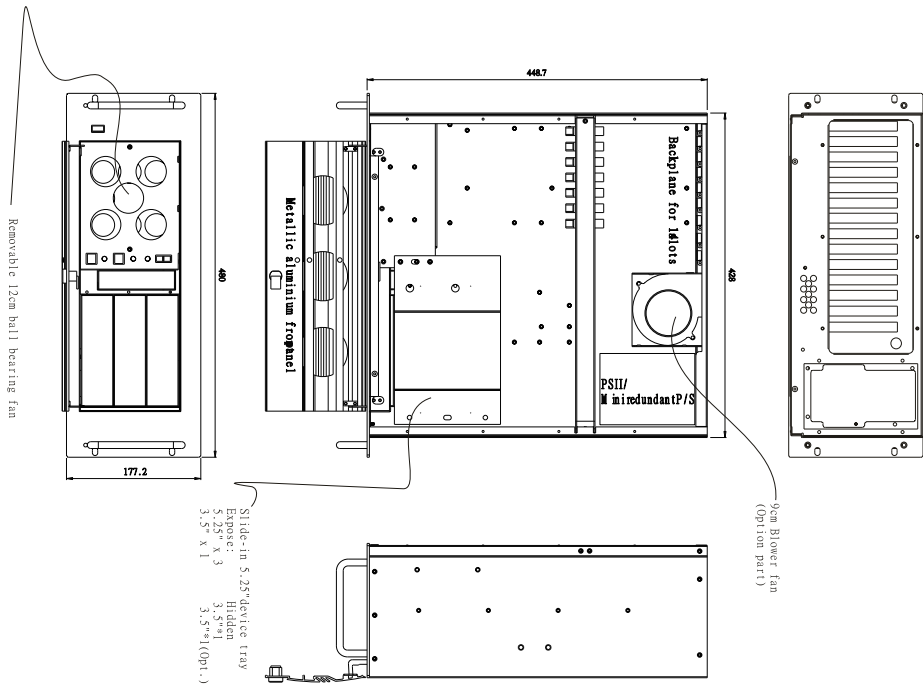

Ordering Information

Model	Description
E-4140	4U Rugged 14-slot Compact 17" Rackmount Chassis

Compatible Power

PSU Model	Description
IS-400R8P	IS 400w x 2 redundant
IS-550R8P	Mini 550w Redundant
TC-700PD8B	700W 80PLUS Bronze ATX PSU

Optional Accessories

Category	Model
Drive Cage	BPN Trayless Drive Cage Series BPU Tray Drive Cage Series
Sliding Rail Kit	TC-RAIL Series Sliding Rail Kit