

# E204L-M1B3SA

2U EATX Rugged Rackmount 4x3.5"  
Hotswap Chassis



## Features

- 1.2mm Steel Body Chassis
- 80mm x4 Cooling Fans
- Supports E-ATX Motherboard
- Supports Front Access USB2.0 x2
- 4x 3.5" Hotswap Drive Bays with Optional Color

## Specifications

Model Number	Supported PSU Type	Cooling Fan	
E204L-M1B3SA	2U	4x80mm	
RoHS Compliance	Expansion Slots	Dimensions (WxHxD)	
YES	6x low profile	Width	19.00" ( 482.6 mm )
Form factor	Material of Handle	Height	3.50" ( 88.9 mm )
2 U	Aluminum	Depth	25.10" ( 637.5 mm )
Standard Drive Bays	Material of Main Chassis		
3.5" Drives: 2      5.25" Drives: 1	Zinc-Coated Steel SECC 1.2mm		
Hotswap 3.5": 4	Color of Main Chassis		
Hotswap HDD Type:	Black		
3.5" SAS I/II & SATA I/II/III	Front Connector		
Indicators	2x USB 2.0		
Power, HDD	Motherboard Size		
Switches	12 x 13 (EATX, ATX, microATX)		
Power, Reset			

## Front View



## Inside View

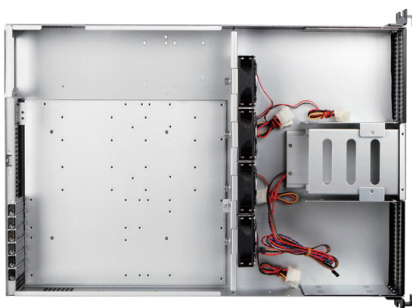

## Rear View



We at iStarUSA Group offer OEM/ODM services for Industrial Power, Custom Power, Chassis, Cabinets, and Data Storage. Through our skilled metal bending, milling, and silk screening we can provide you with unique customizations that will make your product stand out from the rest. With iStarUSA Group's OEM/ODM Solutions you can be sure to receive one-of-a-kind products for your one-of-a-kind business.

## Dimensions

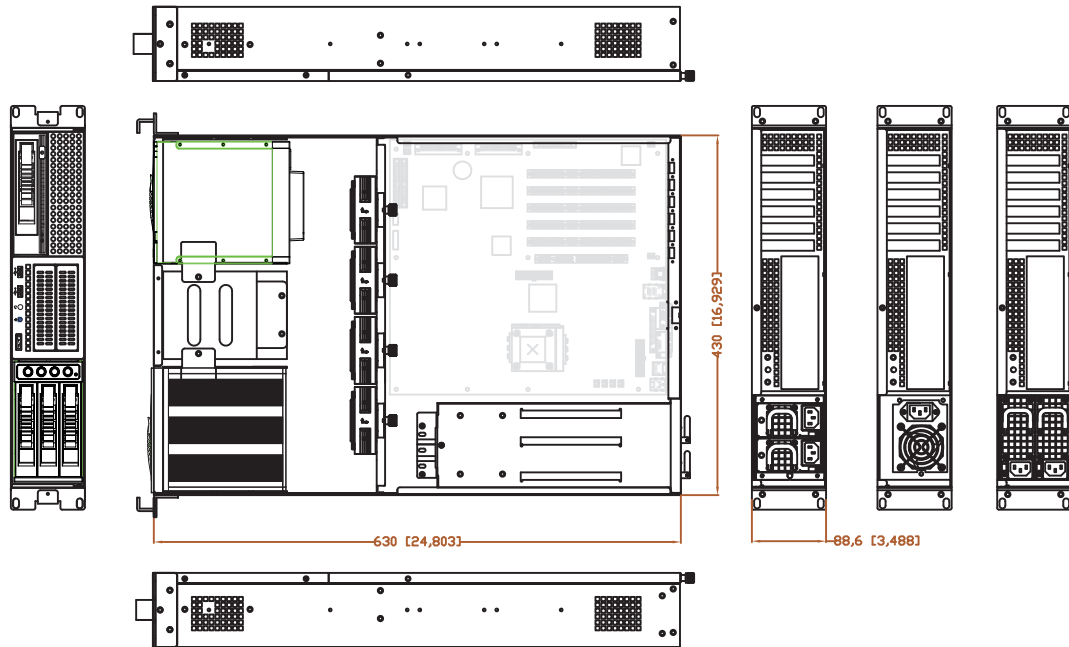

## Ordering Information

Model	Description
E204L-M1B3BK	E204L-M1B3SA with Black HDD Handle
E204L-M1B3BL	E204L-M1B3SA with Blue HDD Handle
E204L-M1B3RD	E204L-M1B3SA with Red HDD Handle
E204L-M1B3SL	E204L-M1B3SA with Silver HDD Handle

## Compatible Power

PSU Model	Description
IS-2U35PD8	IS 2U 80PLUS 350W
IS-2U46PD8	IS 2U 80PLUS 460W

## Optional Accessories

Category	Model
Drive Cage	BPN Trayless Drive Cage Series BPU Tray Drive Cage Series
Sliding Rail Kit	TC-RAIL Series Sliding Rail Kit