

E2M2R

2U 2-Bay Server Rackmount Chassis



Features

- Support Redundant Power Supply
- Ultra Compact 16" Body Depth
- Fiber Optical Drive Tray Status Indicator
- Support ATX Motherboard
- Front Access USB Connector
- Power & HDD LED Indicator and Power & Reset Switch
- Fully RoHS Compliance
- Support 6.0Gb/s SAS/SATA Hard Drives

Specifications

Model Number		Expansion Slots	
E2M2R		3	
RoHS Compliance		Material of Front Bezel	
YES		Texture-Coated	
Form factor		Material of Handle	
2 U		Aluminum	
Standard Drive Bays		Material of Main Chassis	
3.5" Drives: 1	Hotswap 3.5": 2	Heavy-duty SGCC Cold-rolled Steel	
3.5" Drive (internal): 1	Slim 5.25" Optical: 1		
Hotswap HDD Type:		Motherboard Size	
3.5" SAS I/II & SATA I/II/III		12 x 9.6 (ATX, microATX)	
Indicators		Cooling Fan	
Power + HDD LED		2x40mm	
Switches		Dimensions (WxHxD)	
Power On/Off, Reset		Width	19.00" (482.6 mm)
		Height	3.50" (88.9 mm)
		Depth	16.00" (406.4 mm)

Front View



Inside View

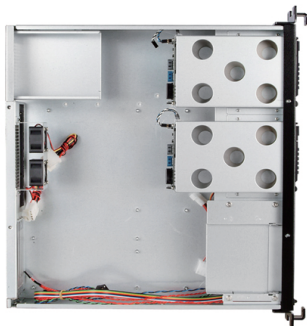

Rear View



We at iStarUSA Group offer OEM/ODM services for Industrial Power, Custom Power, Chassis, Cabinets, and Data Storage. Through our skilled metal bending, milling, and silk screening we can provide you with unique customizations that will make your product stand out from the rest. With iStarUSA Group's OEM/ODM Solutions you can be sure to receive one-of-a-kind products for your one-of-a-kind business.

Dimensions

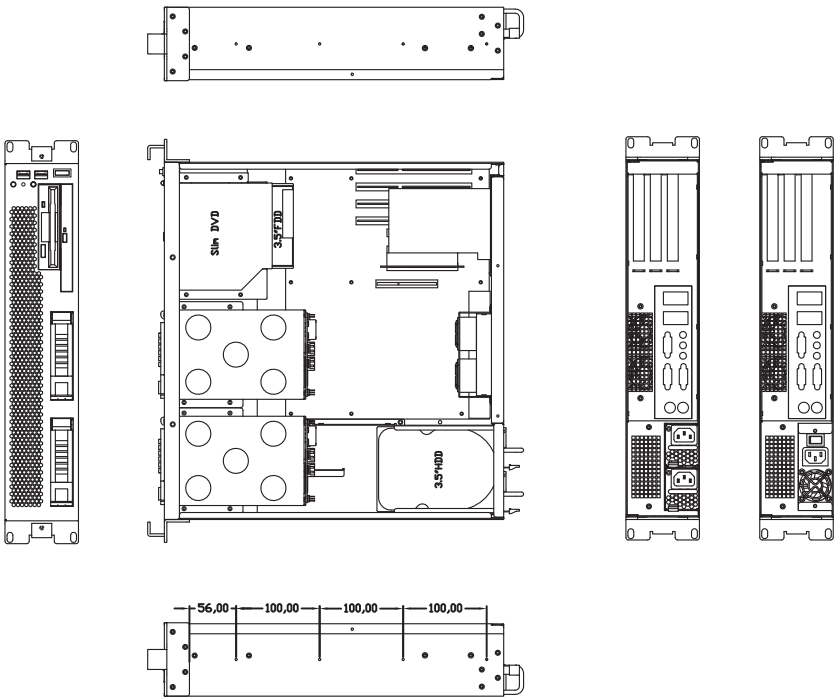

Ordering Information

Model	Description
E2M2R	2U 2-Bay Server Rackmount Chassis

Compatible Power

PSU Model	Description
IS-1U40PD8	IS 1U 80PLUS 400W
IS-1U50PD8	IS 1U 80PLUS 500W

Optional Accessories

Category	Model
Sliding Rail Kit	TC-RAIL Series Sliding Rail Kit

Compatible Riser Card

Model	Description
DD-630660-C7	2U 2 PCIe x16 Riser Card
DD-741611-C7	2U Riser card-1 PCIe x16 and 2 PCI32 Riser Card

** We offer a great selections of riser cards.Please contact our sales engineers for other specs of riser cards*