

T-G35-HD 2.5" Industrial 12Gb/s Hot-Swap Rack

User's Manual



iStarUSA - Powered by iStarUSA Group

727 Phillips Drive City of Industry, CA 91748
United States of America

Tel: 1-626-303-8885

Toll-Free: 1-888-989-1189

Email: sales@istarusa.com



Specifications:

Hot Swap	1x2.5"HDD
Standard Drive Bays	3.5" Drive: 1
Dimension (W x H x D)	101.6mm x 25.4mm x 143.3mm
Material	Metal with Anti-rust Coating
HDD Interface	SAS / SATA
Weight	0.88 lbs
Cable	SATA Cable Included (1pc)

Order Information:

Model Number:	Color:	UPC Code:
T-G35-HD	Black	846813042277

Introduction:

T-G35-HD is iStarUSA's new generation screw-less hot-swap hard drive cage. It features the latest transfer rate technology of 12Gb/s and supports all standard HDDs on the market. By popular demand, the LED display lights feature the new blue light to show drive activity and red light for HDD accessing. The SATA power connector increases compatibility with most power supplies. The metal key locks and thumbscrews help to secure your hard drives from any unauthorized access.

Features:

- Patent screw-less 2.5" HDD mounting design
- Power/drive activity LEDs
- Point to point transferring data design
- Stainless steel handle
- Cable-less connection, support plug & play, hot-swappable
- Aluminum body for best cooling
- High performance transfer rate up to 12Gb/s
- Supports 2.5" SAS I/II/III & SATA I/II/III HDD/SSD
- Support all standard HDDs on the market

Hardware Information: Front View

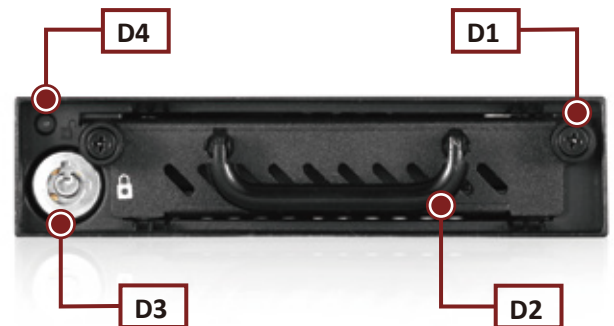

D-1

Thumbscrew: The thumbscrew provide the convenient way to secure your hard disk.

D-2

The metal handle: The strong metal handle can bear heavy user to plug in and out.

D-3

Safety lock: The safety lock safeguards the hard disk in the correct position and prevents unauthorized access.

D-4

Power & HDD access LED. power on, LED indicates blue. red blinking for HDD access.

Hardware Information: Rear View

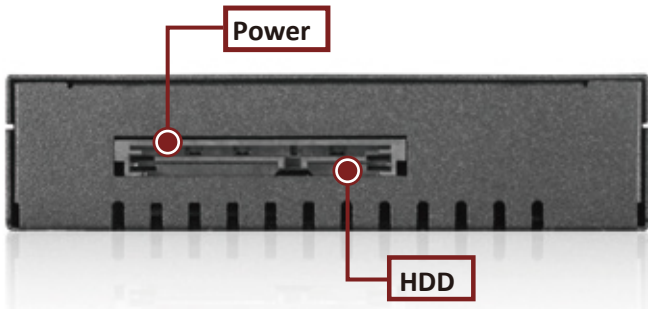

Power: 15pin SATA power connector
HDD: SATA 7Pin data single connector for SATA or SAS primary channel connections.

Hard Drive Installation

1) Unscrew and unlock the tray, then hold the handle to pull out the HDD tray.

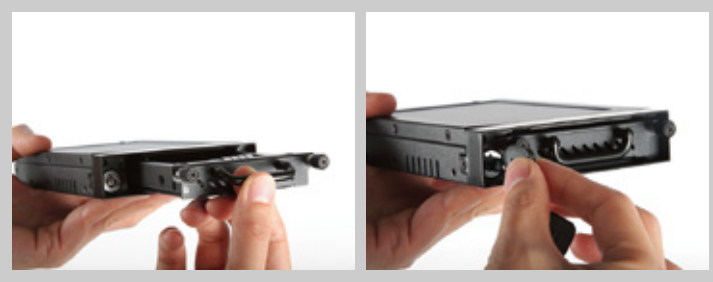

2) Slide HDD into the tray, and make sure the HDD is secured with plastic latch installed.



3) Plug the tray back, lock and tight the thumbscrew.

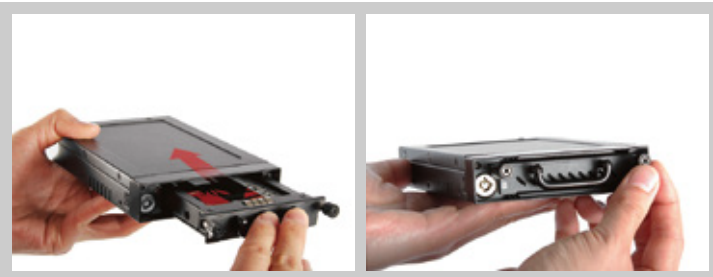

Hard Drive Removal

1) Unlock and unscrew the tray.



2) Pull the lever outwards and HDD will be release from the backplane as the handle is being pulled.



3) Hold down plastic latch and release HDD from the rear (Image 3.1) or unscrew HDD (Image 3.2)



Accessories

- Screws & Keys
- 1 SATA cable

