

## T5F-SS 3.5" SATA/SAS HDD Cage

### User's Manual



### Specification:

Hot Swap	1x3.5"HDD
Cooling Fan	1x40mm
Standard Drive Bays	5.25" Drive: 1
Dimension (W x H x D)	5.75 x 1.57 x 7.48 inches
Material	Frame: Metal, Front Panel: Plastic
HDD Interface	3.5 SATA I/II / SAS I
Weight	1.5 lbs
Connector	4-pin Molex power and 7-pin Data
Indicators	Power On: blue, HD Access: blue blinking

### Order Information:

Model Number:	Color:	UPC Code:
T5F-SS	Black	846813010672

**iStarUSA** – Powered by iStarUSA Group  
727 Phillips Drive  
City of Industry, CA 91748  
Tel: (888) 989-1189  
Email: sales@istarusa.com



### Introduction:

T5F-SS is a mobile rack for use with 3.5" SAS and SATA I/II hard drive. The storage capacity of the hard drive is unlimited. The trayless and screwless design is for fast and easy installation. The anti-vibration design gives hard drive an extra protection from damage. Blue LED indicator enables monitor power and hard drive activities. Security key-lock prevents intrusion and theft to the most important Data.

### Features:

- Screwless and Trayless Design for fast HDD mounting
- Anti-vibration Design
- Support SAS and SATA I/II Hard drive
- Key Lock Prevents Theft or Removal During Operation
- Fit for Standard 5.25" Drive Bay
- Best Air Ventilation with 1 x 40mm Fan

### Hardware Information: Front View

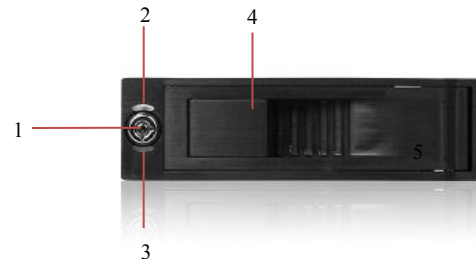

Picture A

- A 1:** Key Lock: keeps the HDDs staying inside the unit and prevents HDDs being taken out while they are running  
**A 2:** Power LED: Power on, LED indicates blue.  
**A 3:** HDD Access LED: Blue blinking for HDD access.  
**A 4:** HDD Cage release latch

## Hardware Information: Rear View

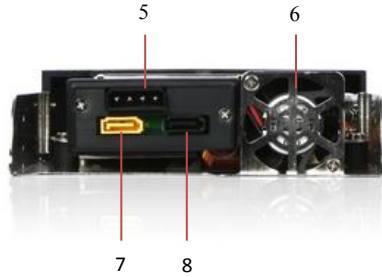

Picture B

**B5:** 4pin Molex power connector

**B6:** 40mm Cooling Fan

**B7:** Primary Channel (yellow) → for SAS HDD data ports & advanced users.

**B8:** Secondary Channel (black) → for SATA or SAS HDD data ports

\*Note for Connections:

- For SATA HDDs, they are supported by Secondary ports (B8) only.
- For SAS HDDs, they are supported by both Primary & Secondary channels.
- Dual channel SAS control card or two systems (PC) are needed if both primary & secondary ports need to be used simultaneously.

## HDD Installation:

- Pull the spring lock to open the front door.

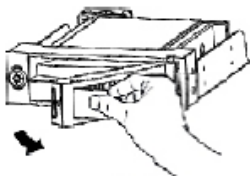

- Place the hard drive into T5F-SS with the label (printed) side up. Make sure the hard drive connectors side is inserted into T5F-SS

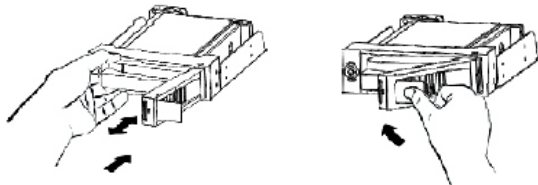

## Installing T5F-SS

- Remove the cover of an empty drive bay.

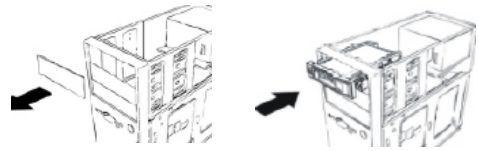

- Smoothly insert T5F-SS into the bay and push it inward until the T5F-SS screw hole aligned with the hole of the bay.
- Secure T5F-SS with screws. Use two screws on each side will be good for T5F-SS safety function.

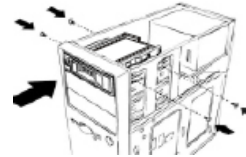

## Accessories:

- 1 manual
- 2 keys
- 4 screws



## iStarUSAcare:



We will help you navigate our website to find the information that you need. Go to [www.istarusa.com](http://www.istarusa.com), and click on live chat bubble above the Search Bar.

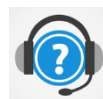

Our technicians are standing by to take your questions. Visit <http://istarusa.com/support/>, and you will receive a technical support ticket to help track your requests from the beginning to the end. Or you can contact us @ 888-989-1189.

### FCC and CE Radiation Norm

#### FCC

This equipment has been tested and found to comply with limits for Class B digital device pursuant to Part 15 of Federal Communications Commission (FCC) rules.

#### CE

This equipment has been tested and found to comply with the limits of the European Council Directive on the approximation of the law of the member states relating to electromagnetic compatibility (89/336/EEC) according to EN 55022 Class B.

#### FCC and CE Compliance Statement

These limits are designed to provide reasonable protection against frequency interference in residential installation. This equipment generates uses and can radiate radio frequency energy, and if not installed or used in accordance with the instructions may cause harmful interference to radio communication. However, there is no guarantee that interference will not occur in television reception, which can be determined by turning the equipment off and on. The user is encouraged to try and correct the interference by one or more of the following measures: Reorient or relocate the receiving antenna. Increase the separation between the equipment and the receiver, connect the equipment into an outlet on a circuit different from that to which the receiver is connected to.

#### CAUTION!

The Federal Communications Commission warns the user that changes or modifications to the unit not expressly approved by the party responsible for the compliance could void the user's authority to operate the equipment.