

# V-2-M2SA

## 2U 2-Bay Storage Server Rackmount Chassis



### Features

- Industrial Grade Aluminum Drive Tray Handle with iStarUSA Signature Design
- RoHS Compliance
- Power, HDD, Alarm Led, and Power ON/OFF, Alarm Rest Switch
- Front Access USB Connector
- Single/MultiLane SATA, MultiLane SAS, and D-Sub Backplane Option
- Advance Thermal Cooling Design that Optimize Airflow
- Fiber Optical Drive Tray Status Indicator
- Ultra Compact 15" Body Depth

### Specifications

Model Number		Expansion Slots
V-2-M2SA		3
RoHS Compliance		Material of Handle
YES		Aluminum
Form factor		Material of Main Chassis
2 U		Heavy-Duty Cold-Roll Steel
Standard Drive Bays		Color of Main Chassis
3.5" Drive (internal): 2	Slim 3.5" FDD: 1	Black
Hotswap 3.5": 2	Slim 5.25" Optical: 1	
Hotswap HDD Type:		Motherboard Size
3.5" SATA I/II		12 x 9.6 (ATX, microATX)
Indicators		Cooling Fan
Power, HDD, Fan		2x40mm
Switches		Dimensions (WxHxD)
Power, Reset		Width 19.00" ( 482.6 mm )
		Height 3.50" ( 88.9 mm )
		Depth 15.00" ( 381.0 mm )

### Front View



### Inside View

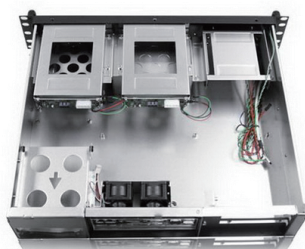

### Rear View



We at iStarUSA Group offer OEM/ODM services for Industrial Power, Custom Power, Chassis, Cabinets, and Data Storage. Through our skilled metal bending, milling, and silk screening we can provide you with unique customizations that will make your product stand out from the rest. With iStarUSA Group's OEM/ODM Solutions you can be sure to receive one-of-a-kind products for your one-of-a-kind business.

## Dimensions

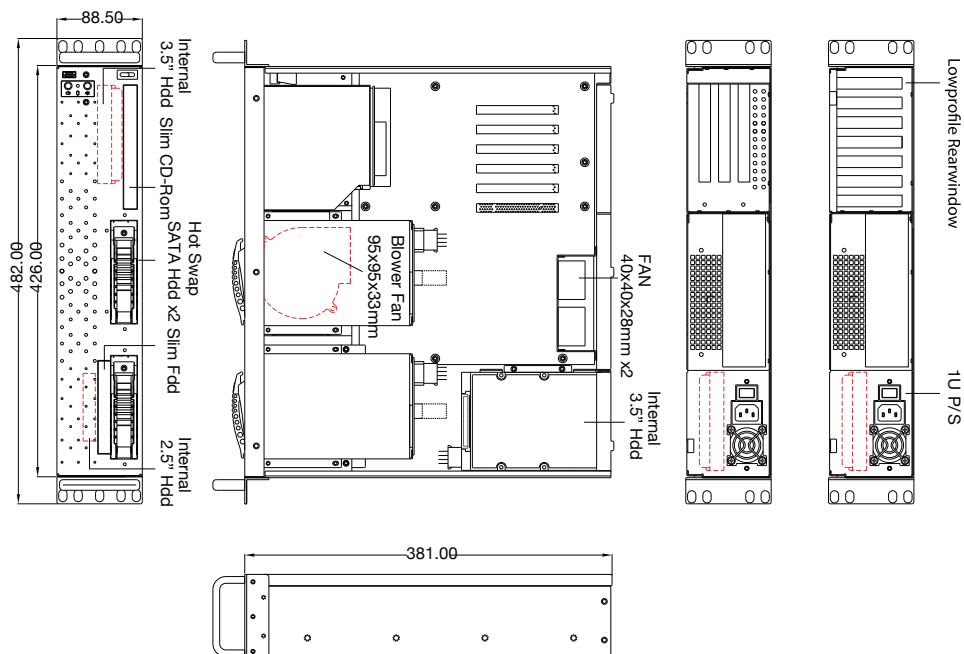

## Ordering Information

Model	Description
V-2-M2SA-BLACK	V-2-M2SA with Black Tray
V-2-M2SA-RED	V-2-M2SA with Red Tray
V-2-M2SA-SILVER	V-2-M2SA with Silver Tray

## Compatible Power

PSU Model	Description
IS-1U40PD8	IS 1U 80PLUS 400W
IS-1U50PD8	IS 1U 80PLUS 500W

## Compatible Riser Card

Model	Description
DD-630660-C7	2U 2 PCIe x16 Riser Card
DD-741611-C7	2U Riser card-1 PCIe x16 and 2 PCI32 Riser Card

*\* We offer a great selections of riser cards. Please contact our sales engineers for other specs of riser cards*